

**Included in package:**

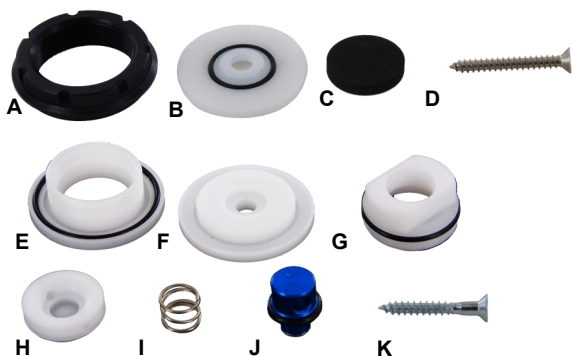

- A: Flexible Inner Retaining Ring
- B: Flexible Inner Valve Dummy (Blue)
- C: Large Foam Circle (2)
- D: Flexible Inner Attachment Screw (Long)
- E: Push Button Valve Base
- F: Push Button Valve Dummy
- G: Push Button Valve Housing
- H: Push Button Valve Seat
- I: Push Button Valve Spring
- J: Push Button Valve Element
- K: Dummy Attachment Screw

Manufactured by:



419 N. Curtis Rd., Boise, ID 83706 USA  
(208) 429-0026 | www.coyotedesign.com

# CD105PBF

## Push Button Valve for Flexible Inner Socket

Push button manual expulsion valve. Works with flexible inners.

Install using fabrication tooling.



2-Year warranty against manufacturer defects, excessive wear or breakage

Made in U.S.A.

External Prosthetic Components



EC REP

Advena Ltd  
Pure Offices, Plato Close  
Tachbrook Park  
Warwick, CV34 6WE, UK



CD105PBF.revA.06272018

**Included in package:**

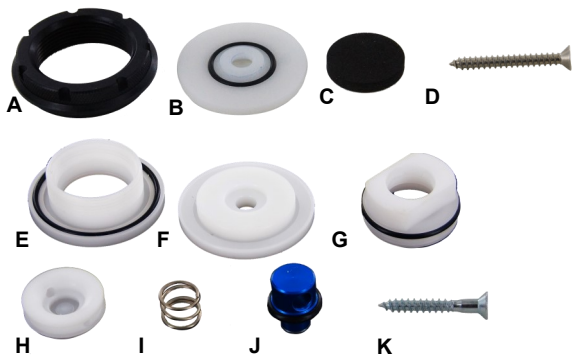

- A: Flexible Inner Retaining Ring
- B: Flexible Inner Valve Dummy (Blue)
- C: Large Foam Circle (2)
- D: Flexible Inner Attachment Screw (Long)
- E: Push Button Valve Base
- F: Push Button Valve Dummy
- G: Push Button Valve Housing
- H: Push Button Valve Seat
- I: Push Button Valve Spring
- J: Push Button Valve Element
- K: Dummy Attachment Screw

Manufactured by:



419 N. Curtis Rd., Boise, ID 83706 USA  
(208) 429-0026 | www.coyotedesign.com

# CD105PBF

## Push Button Valve for Flexible Inner Socket

Push button manual expulsion valve. Works with flexible inners.

Install using fabrication tooling.



2-Year warranty against manufacturer defects, excessive wear or breakage

Made in U.S.A.

External Prosthetic Components



EC REP

Advena Ltd  
Pure Offices, Plato Close  
Tachbrook Park  
Warwick, CV34 6WE, UK



CD105PBF.revA.06272018

## INSTRUCTIONS —

### Use Flexible Inner Retaining Ring for extra depth when creating a socket with a flexible inner.

- 1 Choose valve placement on mold.
- 2 Make a flat spot on mold with Surform so valve dummy sits flush on mold.
- 3 Drill hole through center of dummy hole into mold. Place the Push Button Valve Dummy so the screw recess hole is facing out.
- 4 Place dummy on cast and apply screw to attach dummy to mold. Place large foam circle on center of dummy to create sanding guide.
- 5 Pull flexible inner plastic over mold and valve dummy.
- 6 Grind to foam circle and remove. Grind to face of valve dummy and expose surface.
- 7 Remove screw.
- 8 Place the (blue) Flexible Inner Valve Dummy over the Push Button Valve Dummy and screw it into place with the longer screw.
- 9 Center and place the 2nd foam dot over (blue) Flexible Inner Valve Dummy.
- 10 Laminate the socket as preferred.
- 11 Grind to foam circle and remove. Grind to face of valve dummy and expose surface. Remove the screw.
- 12 After breaking out or pulling mold remove dummies. Put silicone bead on O-ring.
- 13 Install valve body in place of valve dummy. Screw metal threaded to valve body. Then install blue push button valve to valve body.

Manufactured by:



419 N. Curtis Rd., Boise, ID 83706 USA  
(208) 429-0026 | [www.coyotedesign.com](http://www.coyotedesign.com)

## INSTRUCTIONS —

### Use Flexible Inner Retaining Ring for extra depth when creating a socket with a flexible inner.

- 1 Choose valve placement on mold.
- 2 Make a flat spot on mold with Surform so valve dummy sits flush on mold.
- 3 Drill hole through center of dummy hole into mold. Place the Push Button Valve Dummy so the screw recess hole is facing out.
- 4 Place dummy on cast and apply screw to attach dummy to mold. Place large foam circle on center of dummy to create sanding guide.
- 5 Pull flexible inner plastic over mold and valve dummy.
- 6 Grind to foam circle and remove. Grind to face of valve dummy and expose surface.
- 7 Remove screw.
- 8 Place the (blue) Flexible Inner Valve Dummy over the Push Button Valve Dummy and screw it into place with the longer screw.
- 9 Center and place the 2nd foam dot over (blue) Flexible Inner Valve Dummy.
- 10 Laminate the socket as preferred.
- 11 Grind to foam circle and remove. Grind to face of valve dummy and expose surface. Remove the screw.
- 12 After breaking out or pulling mold remove dummies. Put silicone bead on O-ring.
- 13 Install valve body in place of valve dummy. Screw metal threaded to valve body. Then install blue push button valve to valve body.

Manufactured by:



419 N. Curtis Rd., Boise, ID 83706 USA  
(208) 429-0026 | [www.coyotedesign.com](http://www.coyotedesign.com)